

TOPPING
Professional

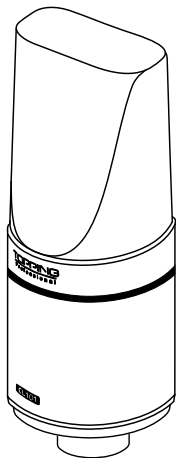

CL101

专业级电容麦克风
Studio Condenser Microphone

产品说明书 | User Manual

前言 Foreword

- 感谢您购买我们的产品，希望您能获得愉悦的录音体验。
Thank you for your purchase. May you have a pleasant recording experience.
- 在您开始使用本产品之前，请详尽阅读本手册，以确保您能够更好地体验本产品。
Please read this manual carefully before using it, to ensure a better experience.
- 请保留包装及购买票据，以作为售后凭证使用。
Please keep the package and purchase receipt as the after-sales certificate.
- 如您在产品使用过程中有其他疑问，请咨询我司客服人员。
Please contact us if there is any fake knockoff. If there are any questions about using the product, please contact our customer service freely.

物品清单 In the box



CL101话筒
CL101 Microphone x 1

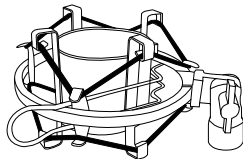

防震架
Shock mount x 1

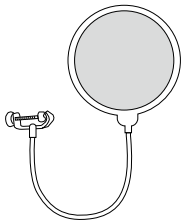

防喷网
Pop filter x 1

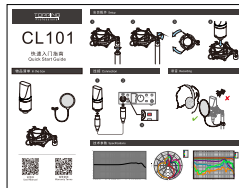

产品入门指南
Quick Guide x 1

安装配件 Setup

1

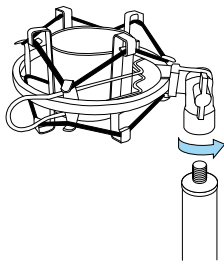

2

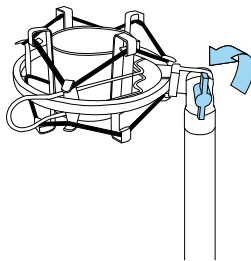

3

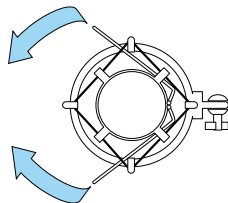

安装配件 Setup

4

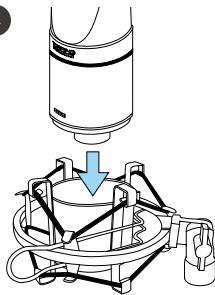

5

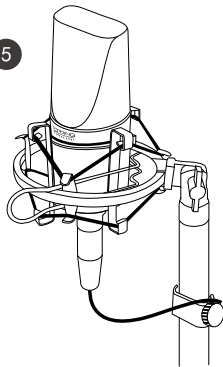

6

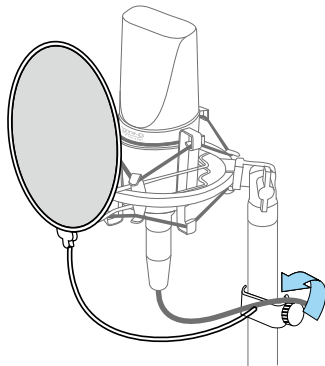

连接 Connection

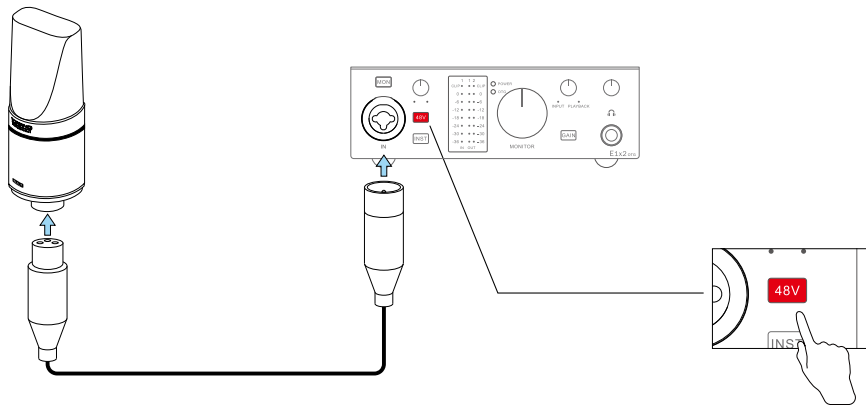

注： 在48V电源启动后插拔话筒将面临损坏设备的风险

Note: Plugging and unplugging the microphone after 48V power is activated will risk damage to the device

录音 Recording

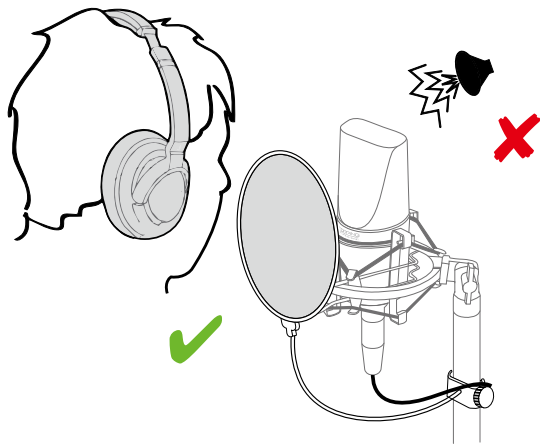

话筒清洁 Cleaning

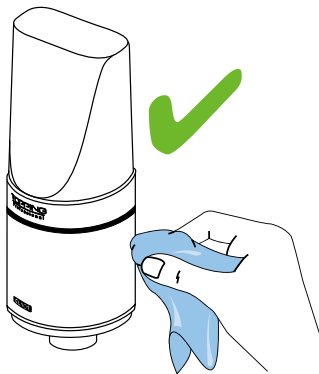

注：话筒可以使用棉布、擦镜纸擦拭，请勿使用湿巾、抹布等含水物体擦拭，以免话筒受潮。

Note: The microphone can be wiped with cotton cloth and mirror paper, do not use wet wipes, rags and other wet objects to wipe, so as to avoid the microphone moisture.

技术参数 Specifications

CL101 参数一览表/Specifications

尺寸/Dimension	ø48 mm x 126 mm
重量/Weight	405g
颜色/Colour	黑,白/Black,White
输出/Connectivity	3针 XLR 接头 (卡农公) /3-pin male XLR connector
类型/Type	电容式, 外部极化/Condenser, externally polarized
振膜直径/Diameter of diaphragm	25.4 mm / 1"
音头直径/Diameter of capsule	34 mm
声学工作原理/Acoustic operating principle	压力梯度传感器/Pressure gradient transducer
指向性/Polar pattern	心型/Cardioid
频率响应/Frequency response	20-20000Hz
灵敏度/Sensitivity	20 mV/Pa
最大声压/Max.SPL	140dB SPL
等效噪声水平/Equivalent noise level	A-weighted: 4dB SPL
内部噪声水平/Internal noise level	A-weighted: <0dB SPL
动态范围/Dynamic range	136dB
标称阻抗/Electrical impedance	<68 Ohms
建议负载阻抗/Recommended load impedance	>1K Ohms
供电/Power requirements	48 V \pm 4 V (P48, IEC 61938)
耗电/Current consumption	5.0mA

频响曲线图 Frequency Response

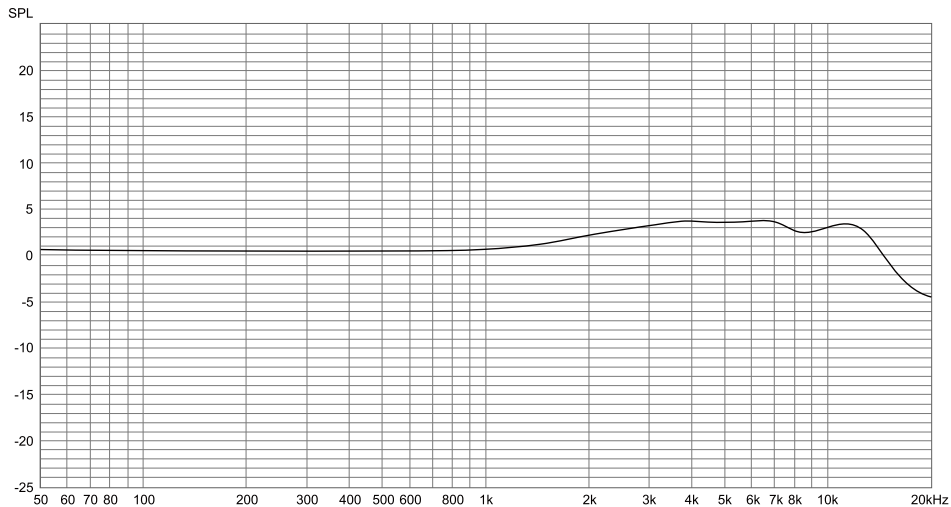

话筒极性图 Polar Pattern

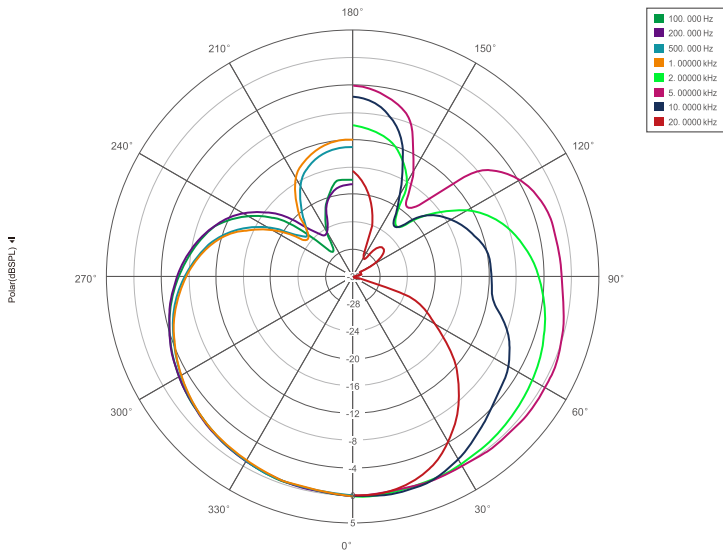

Off axis response (normalized)

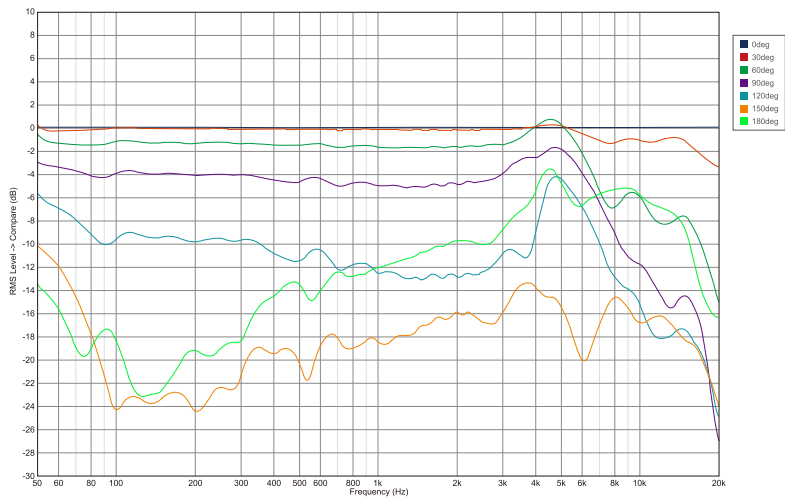

注意事项 Precautions

- 请使用**48V**幻象电源进行供电，不使用时或雷雨天气请关闭**48V**电源。
Please use a 48V phantom power supply for connection, and turn off the 48V power supply when not in use or during thunderstorms.
- 为避免损坏设备，请在进行任何插拔、连接前调低音量并关闭**48V**电源。
To avoid incorrect operation, please lower the volume and turn off the 48V power before making any connections.
- 不得将本机搁置在高温、潮湿的环境，更不得淋雨或者受强烈冲击。
Do not keep the unit in a hot, humid environment or hit the unit strongly.
- 不得随意拆开机壳，如需维修应请专业维修人员处理。
Opening the case instantly voids the warranty!
- 对因产品的故障而直接或间接引起的任何损失或损坏不予负责。
Topping accepts no liability for any loss or damage arising directly or indirectly from the failure of CL101.
- 因产品改进，规格及功能若有变动恕不另行通知。
For improvement purpose, specifications subject to changes without prior notice.